

City of North Las Vegas
 Building and Safety Dept.
 2266 Civic Center Dr.
 No. Las Vegas, Nevada 89036
 (702)633-1550

Residential Room Addition
Typical Framing Plans

B-109-6 6 of 6 3/3/95

City of North Las Vegas
 Building and Safety Dept.
 2266 Civic Center Dr.
 No. Las Vegas, Nevada 89036
 (702)633-1550

Roof Framing Plan

Rafters shall be nailed to adjacent, parallel ceiling joists or minimum 1" x 4" rafter ties @ 4' o.c.

Ridge Board
 Not Less in Depth Than The Cut Ends of The Rafters

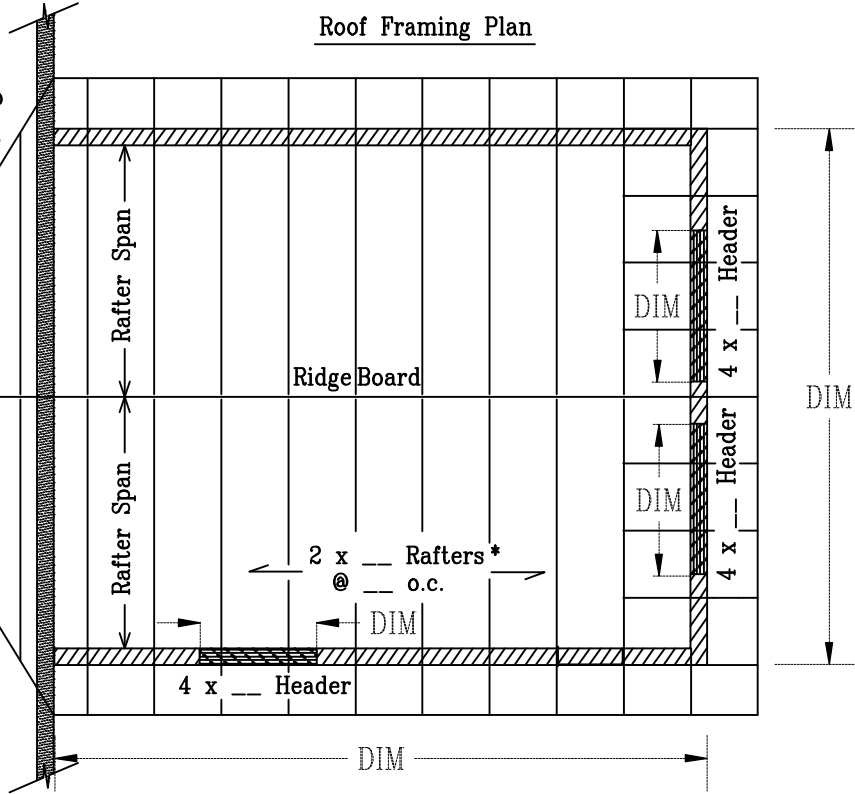

* or Approved
 Manufactured Trusses

Floor Framing Plan if 2nd Story or Crawlspace

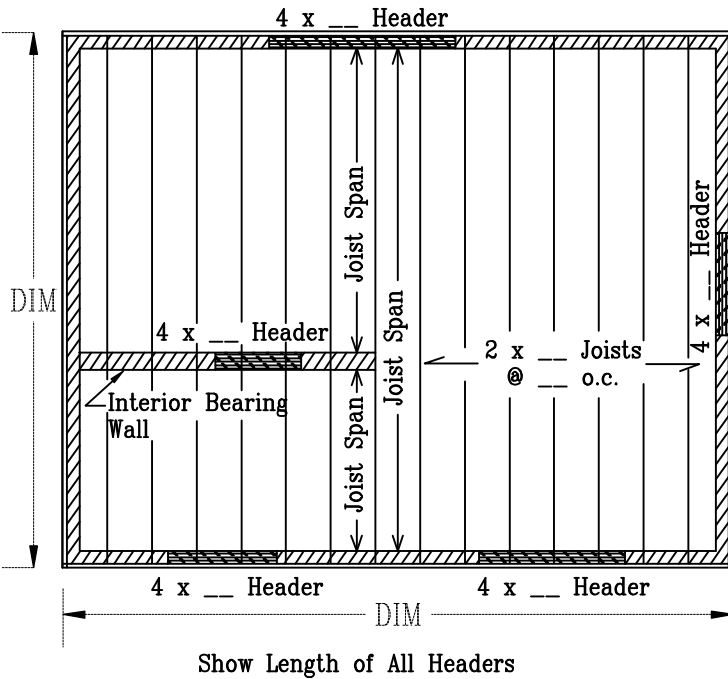

Rafter and Joist Span Table Based on Douglas Fir/Larch #2				
Size (in.)	Spacing	Maximum Allowable Span		
		Floor Joist	Ceiling Joist	Roof Rafter
2x4	12"	—	12' 5"	—
	16"	—	11' 3"	—
	24"	—	9' 10"	—
2x6	12"	10' 9"	19' 6"	13' 6"
	16"	9' 9"	17' 8"	11' 9"
	24"	8' 1"	14' 10"	9' 7"
2x8	12"	14' 2"	25' 8"	17' 2"
	16"	12' 7"	23' 0"	14' 10"
	24"	10' 3"	18' 9"	12' 1"
2x10	12"	17' 9"	32' 5"	20' 11"
	16"	15' 5"	28' 1"	18' 2"
	24"	12' 7"	22' 11"	14' 10"
2x12	12"	20' 7"	—	24' 3"
	16"	17' 10"	—	21' 0"
	24"	14' 7"	—	17' 2"

Rafter sizes based on Composition
 Shingle roof covering